

CUSTOMER	ARCHITECTURAL FENCE & RAILINGS	PART NO. —	DIE NO. AH-78779	DASH 1
DESCRIPTION: —		TARRIF# 7604.21.00.00	PROPOSAL# 38700-2	
		DATE	SYM	REVISION

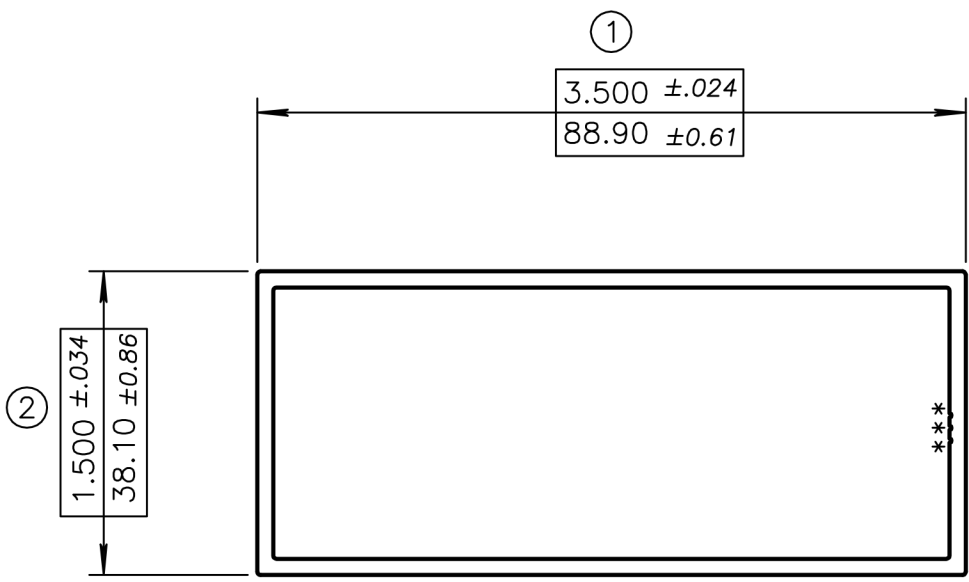

UNMARKED RADII = RADIUS TO SUIT
BREAK CORNERS = 0.016 (0.41) R.

(*) = 0.010(0.25) R. X 0.010(0.25)D. HYDRO I.D. MARKS

ARCHITECTURAL FENCE & RAILINGS	UNSPECIFIED WALL THICKNESS	
	③ 0.080(2.03) ±0.010(0.25) H	
EST. AREA 0.774 IN ² 499 MM ²	OUT PER. 9.973 IN 253 MM	
EST. WT. 0.929 LBS/FT. 1.382 KG/M	FACTOR 21	
EST. PER. 19.339 IN 491 MM	C.C.D. 3.798 IN 96 MM	
DWN BY Danica	ALLOY 6063-T6	SCALE 1:1 DATE 21,04,2021
BREAK ALL CORNERS .016"R (0.41 mm)R UNLESS OTHERWISE NOTED.		STANDARD ALUMINUM ASSOCIATION TOLERANCES TO APPLY UNLESS OTHERWISE SPECIFIED