

DESCRIPTION: —

TARRIF# 7604.29.10.00

PROPOSAL# 37781-1A

DATE

SYM

REVISION

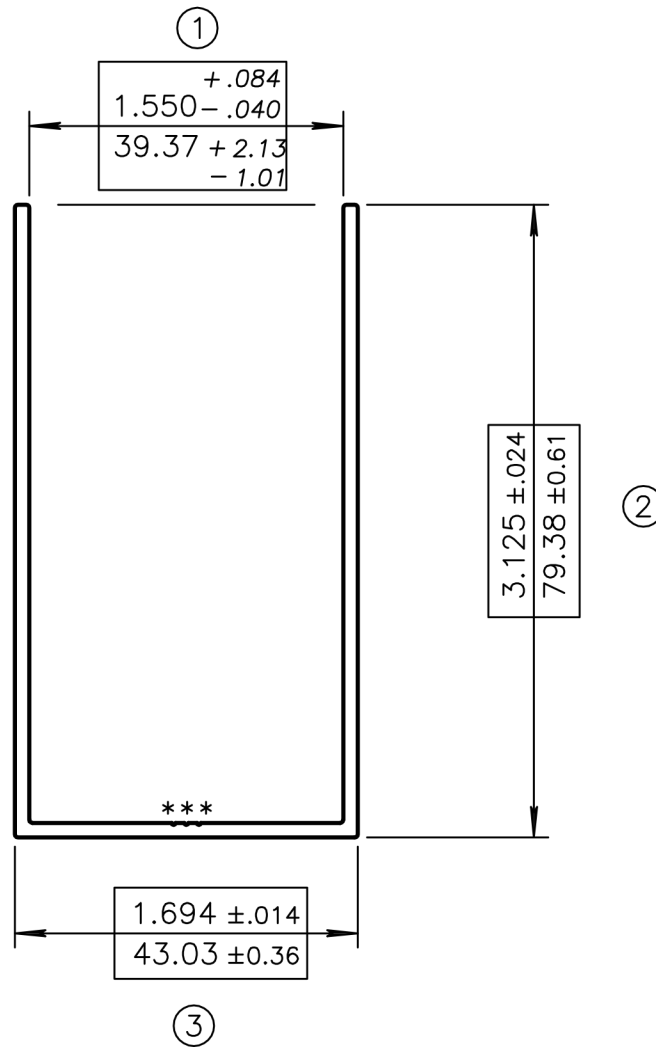

UNMARKED RADII = RADIUS TO SUIT  
BREAK CORNERS = 0.016 (0.41) R.

(\* ) = 0.010(0.25) R. X 0.010(0.25)D. HYDRO I.D. MARKS



UNSPECIFIED WALL THICKNESS

0.072(1.83)  
±0.006(0.15)

EST. AREA 0.561 IN<sup>2</sup> 362 MM<sup>2</sup> OUT PER. — IN — MM

EST. WT. 0.673 LBS/FT. 1.002 KG/M FACTOR 23

EST. PER. 15.723 IN 399 MM C.C.D. 3.543 IN 90 MM

DWN BY Sandra ALLOY 6063-T5 SCALE 1:1 DATE 15,05,2020

BREAK ALL CORNERS .016"R (0.41 mm)R UNLESS OTHERWISE NOTED.

STANDARD ALUMINUM ASSOCIATION TOLERANCES TO APPLY UNLESS OTHERWISE SPECIFIED